

OUR LARGEST SPACE

Exposition Center



ABOUT THE VENUE

Home of the Biggest Events

The new Expo Center is the largest open events space north of New York City between Boston and Cleveland. Flexible space can accommodate anything from concerts and major trade to consumer shows and sporting events.

- Can hold more than 500 10' x 10' trade show booths
- 4,000 retractable seats
- Electronic scoreboard
- Pre-function, VIP and meeting spaces
- Concession/catering facilities
- Inside and outside balconies

SPECIFICATIONS

SIZE
110,000 square feet

SPACE
440' x 250'

SEATING
4,000

TRUSS HEIGHT
60'

RESTROOMS
16

OVERHEAD DOORS
8

ELECTRIC
110/208 non-commercial



nmh
NEW YORK STATE
FAIRGROUNDS

[illegible]

**2020 NEW YORK STATE FAIR
EXPO CENTER Option 2: No Bleachers**

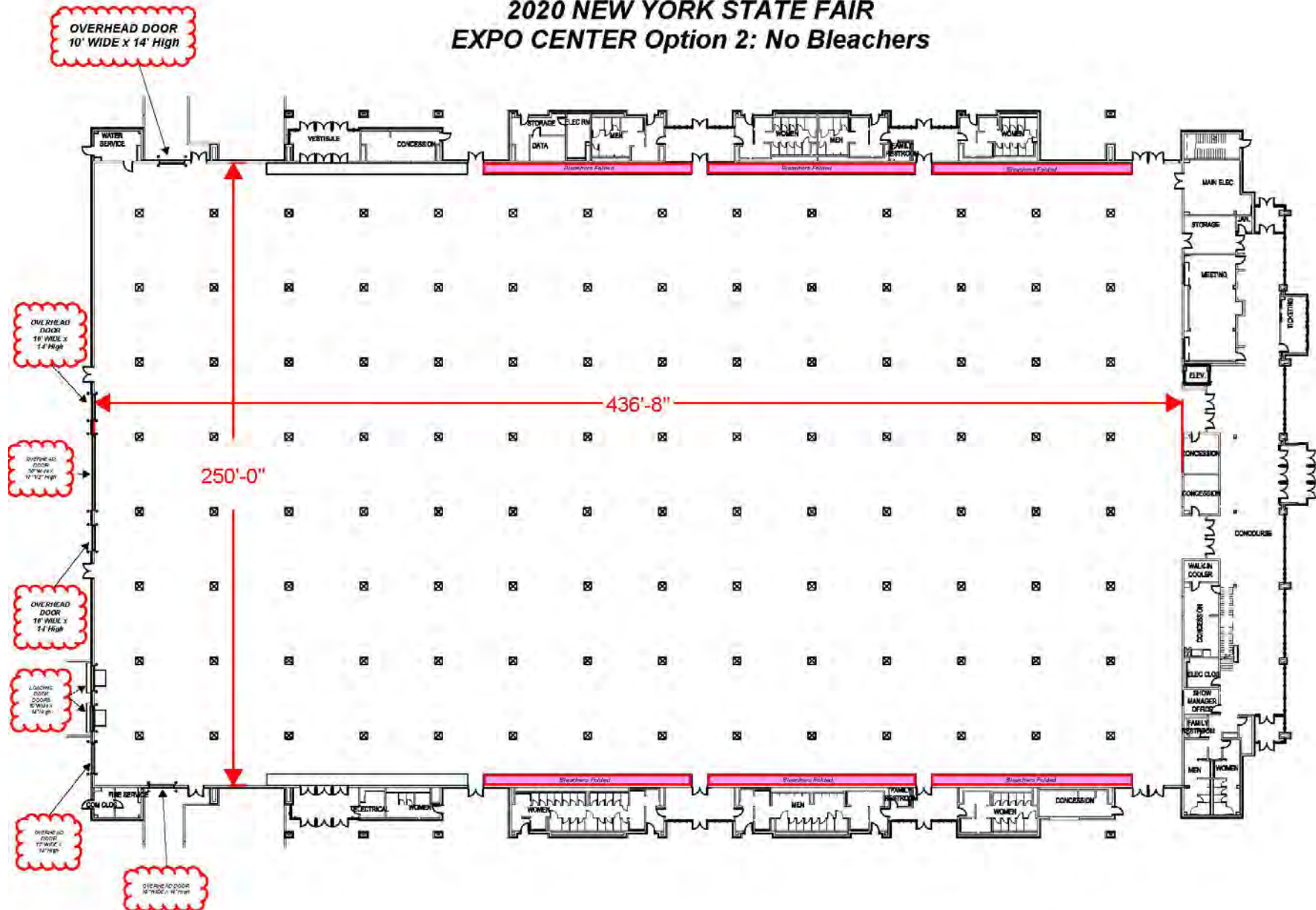

HORSE SHOWS

Toyota Coliseum



ABOUT THE VENUE

Upstate's Home of Horse Shows and More

The Toyota Coliseum hosts more than two dozen regional horse shows a year. The building has seating for 3,600 and an in-house announcer booth. A Fairgrounds restaurant provides concession services for shows.

SPECIFICATIONS

SPACE

210' x 104'

180' x 98'

ELECTRIC

110/208 non-commercial



**NEW YORK STATE
FAIRGROUNDS**

315.487.7711 | 581 State Fair Boulevard, Syracuse, New York 13209

Toyota Coliseum

Toyota Coliseum

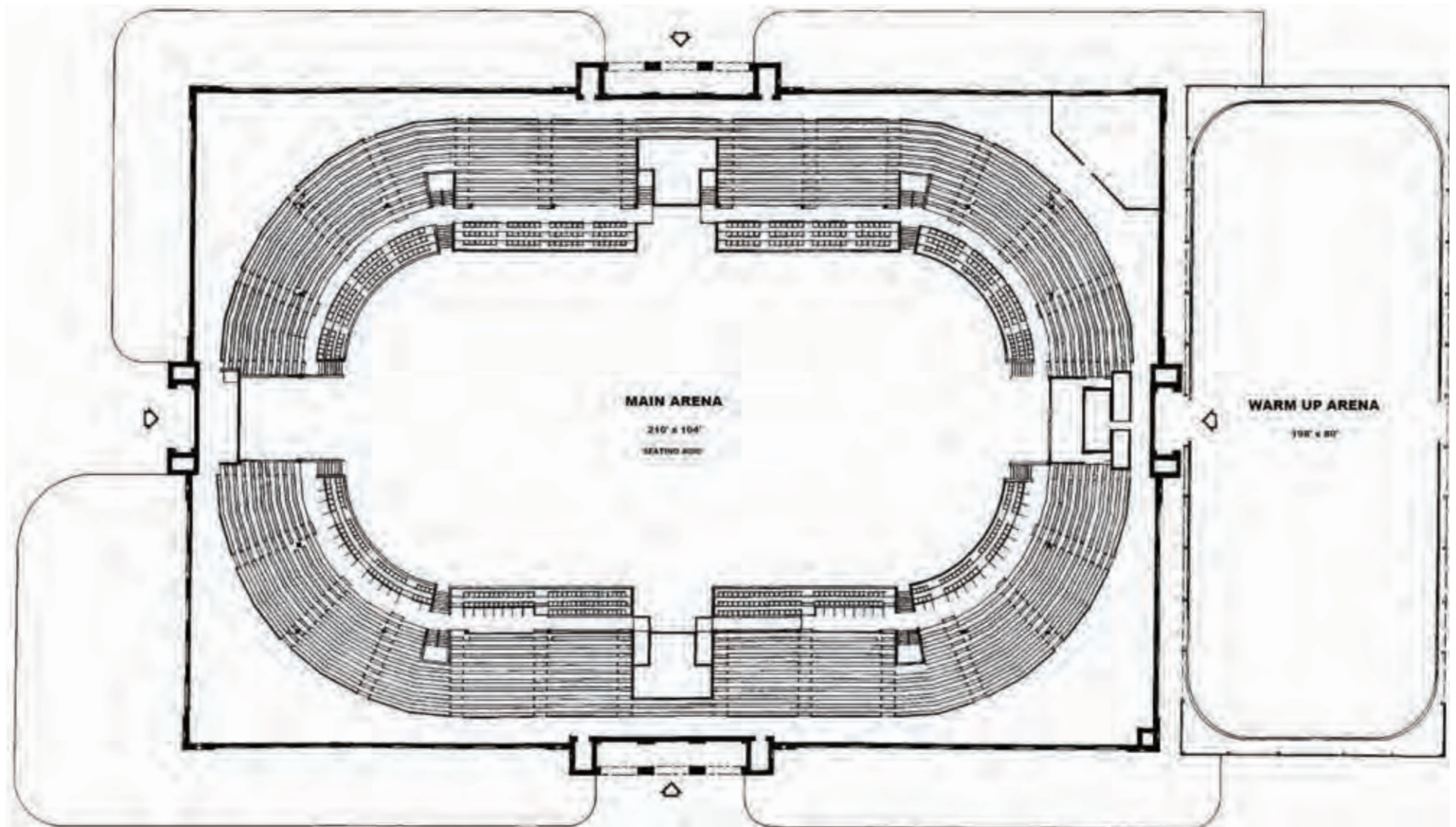

WIDE-OPEN SPACE

Tractor Supply Co. Exhibit Center



ABOUT THE VENUE

Room for a Whole Lot of Show

The Tractor Supply Co. Exhibit Center is the largest of the Fairgrounds' historic buildings. With more than 90,000 square feet of space, there's room here for almost anything, from a trade show to a livestock event. Temporary stalls turn this building into a facility suitable for a cattle show. Many big overhead doors make the load-in and load-out go quickly.

SPECIFICATIONS

SIZE
92,000 square feet

RESTROOMS
4

ELECTRIC
110/208 non-commercial



**NEW YORK STATE
FAIRGROUNDS**

WIDE-OPEN SPACE

Tractor Supply Co. Exhibit Center

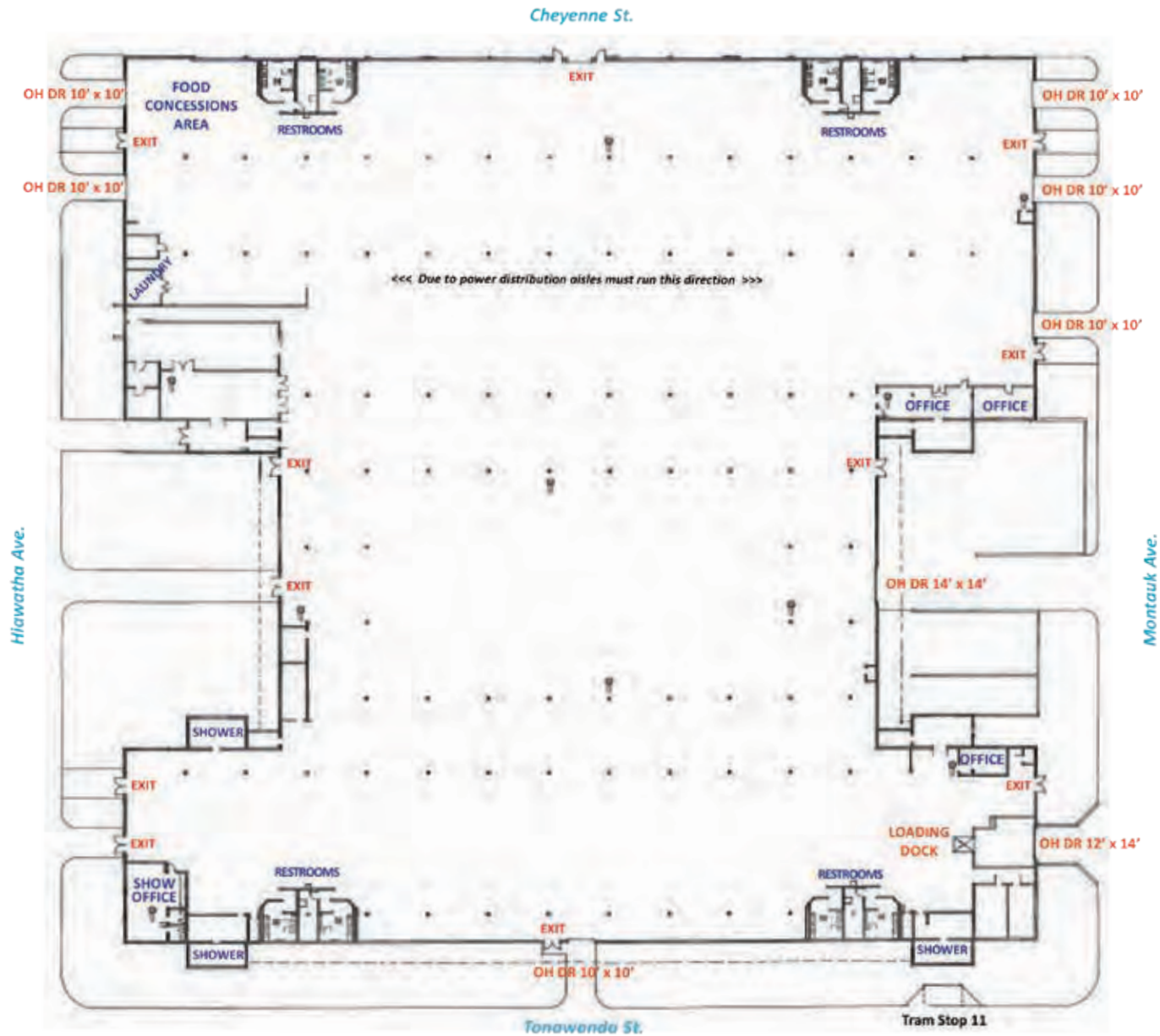

FOR THE BIG SHOWS

Sleep Number Center of Progress



ABOUT THE VENUE

Big Space for a Big Show

The Sleep Number Center of Progress Building is one of the most classic of all Fairgrounds buildings. With approximately 70,000 square feet of wide-open space, this is the place to hold big events and trade shows. The building features a privately operated restaurant and a loading dock that can handle a lot of deliveries.

SPECIFICATIONS

SIZE
70,000 square feet

RESTROOMS
4

ELECTRIC
110/208 non-commercial



NY
NEW YORK STATE
FAIRGROUNDS

315.487.7711 | 581 State Fair Boulevard, Syracuse, New York 13209

Sleep Number Center of Progress

Sleep Number Center of Progress

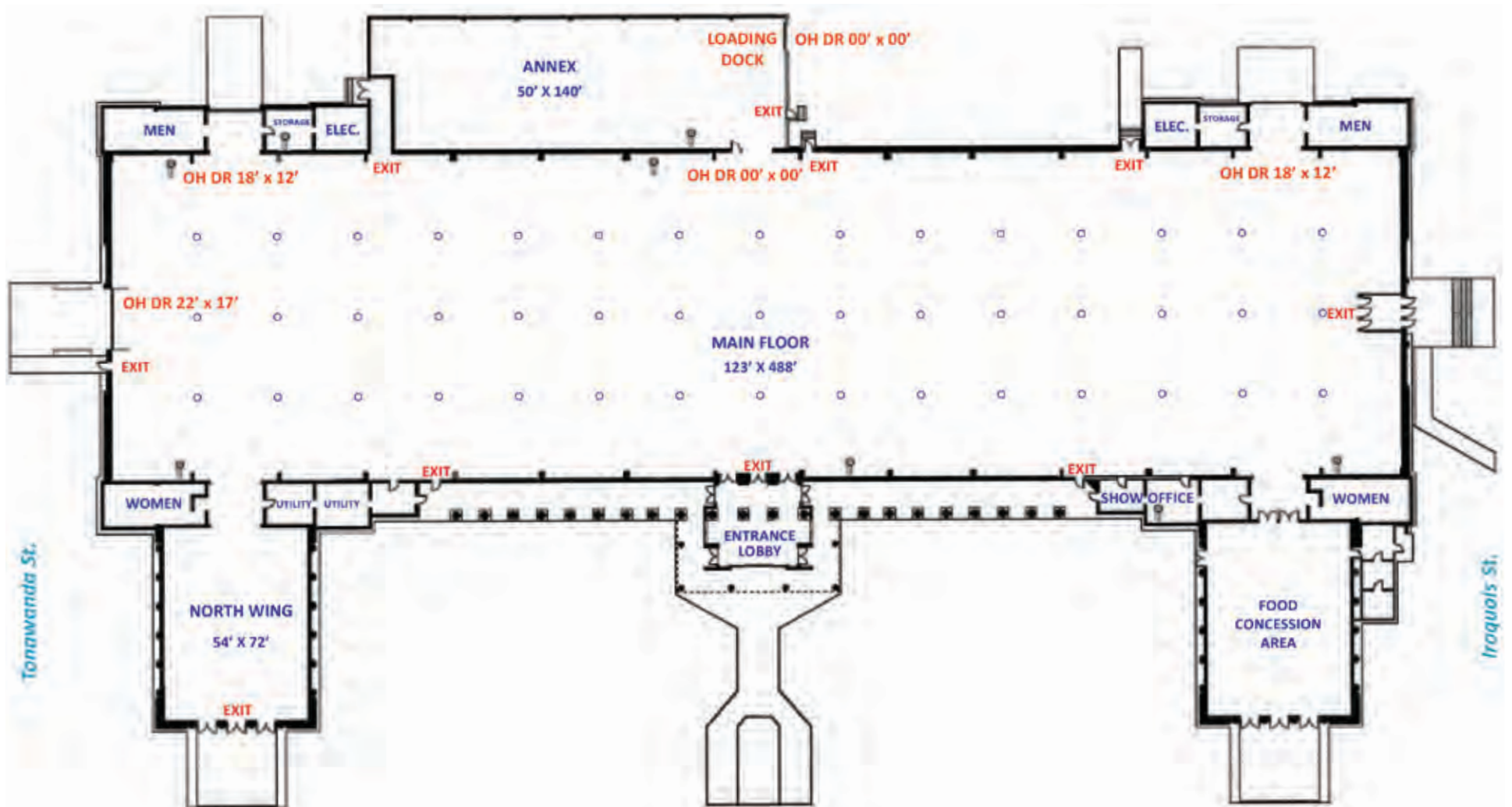

Horticulture Building



Perfect for Mid-Sized Events and Exhibits

If you need a space that's not too big and not too small, the Horticulture Building is the place for your event. At just over 50,000 square feet, it will accommodate lots of activity without feeling crowded. The art deco entrances are a graceful touch.

SIZE
53,000 square feet

RESTROOMS

ACCESS
2 overhead doors

ELECTRICAL
110/208 non-commercial

LIGHTING
400W high-output fixtures

FLOORING Concrete



NEW YORK STATE
FAIRGROUNDS

Horticulture Building

LARGE, OPEN SPACES

Horticulture Building

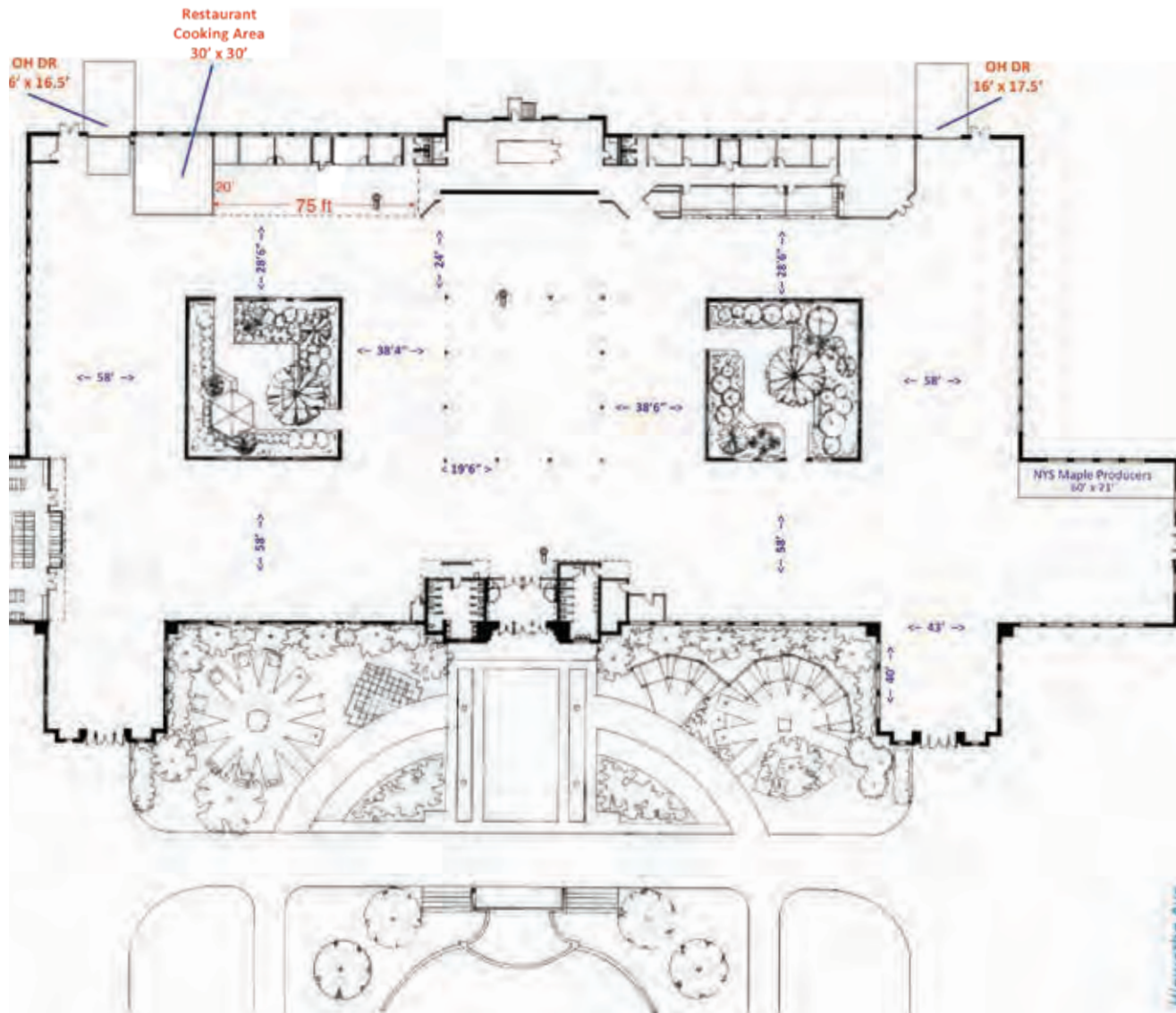

COZY EVENT SPACE

Science & Industry Building



ABOUT THE VENUE

A Home for Smaller Events

The Science & Industry Building is just the right size for a smaller event. It has played host in recent years to indie music concerts, boxing matches, a community garage sale and more. It's also perfect for the event that needs a second building for a special subset of the main event.

SPECIFICATIONS

SIZE
15,946 square feet

RESTROOMS
2

ELECTRIC
110/208 non-commercial



NY
NEW YORK STATE
FAIRGROUNDS

315.487.7711 | 581 State Fair Boulevard, Syracuse, New York 13209

Science & Industry Building

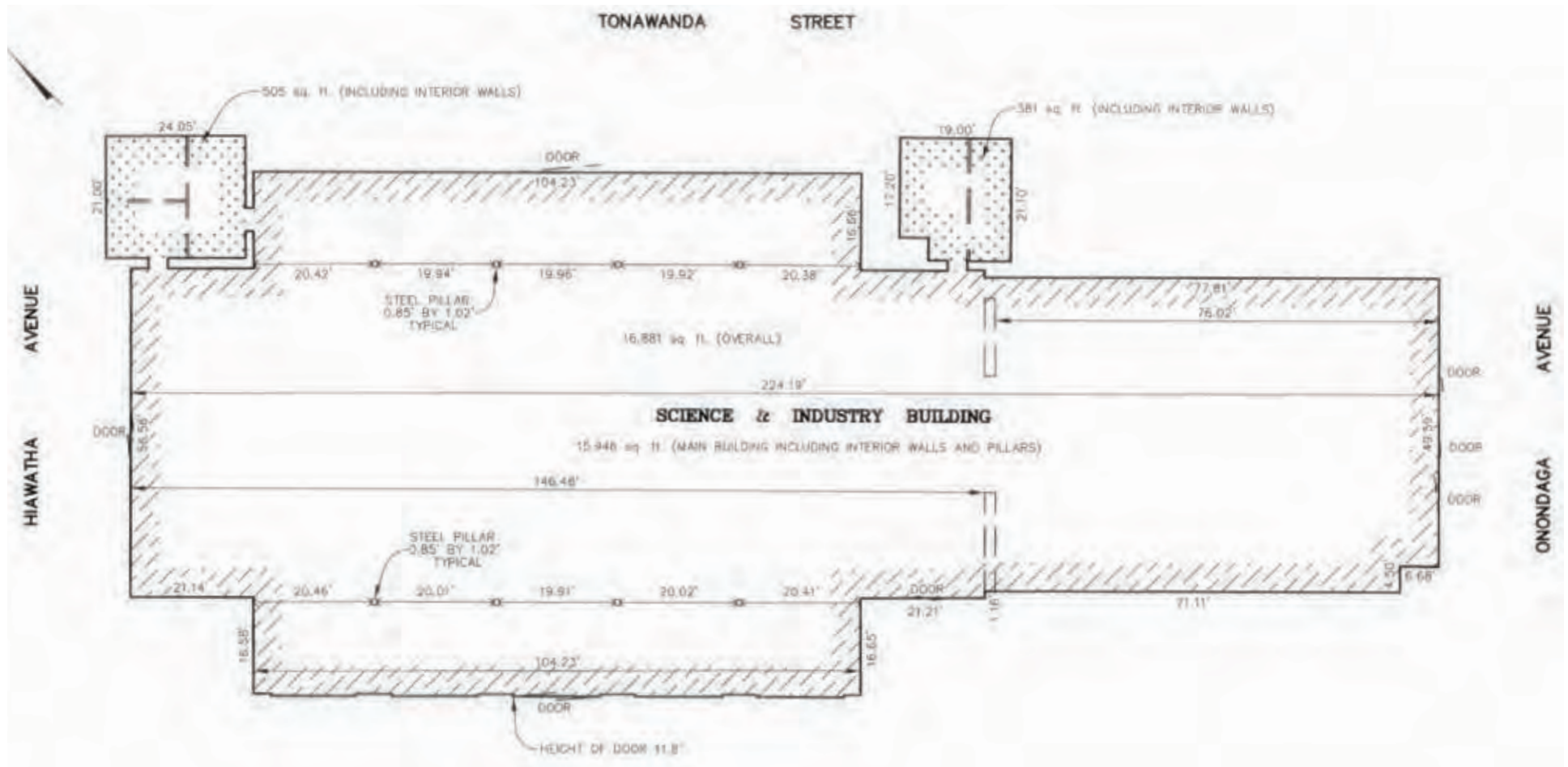

International Building



Quick Access to Food

SPECIFICATIONS

ELECTRIC
110/208 non-commercial



NEW YORK STATE
FAIRGROUNDS

International Building

International Building



Niagara St.

MEETING SPACE

Art & Home Center



ABOUT THE VENUE

Places to Get Together

The Harriet May Mills Art & Home Center is a building made of many spaces, from a room large enough for a wedding reception to an intimate theater and stage to a restaurant and bar. This is a place for meetings and gatherings, a place that can bring people together in intimate surroundings.

SPECIFICATIONS

MEETING ROOMS

4; seat 350, 225, 175, 50

THEATER

Seats 250, with stage

DEMO KITCHEN

Seats 200

ELECTRIC

110/208 non-commercial



nmhm
NEW YORK STATE
FAIRGROUNDS

Art & Home Center



LOWER FLOOR



MAIN FLOOR



SECOND FLOOR AREA

OUTDOOR STAGE

Chevy Court



ABOUT THE VENUE

The Chevy Court stage, located in the heart of the classic section of the Fairgrounds, is a performance stage ideal for concerts, plays and major announcements. During the Fair, the stage has hosted performances from major international music acts, such as Earth Wind & Fire, Bruno Mars and Lady Antebellum. The 68,000-square-foot open-air area will hold a crowd of up to 30,000 people. Chevy Court features a full backstage with multiple dressing rooms.

SPECIFICATIONS

SIZE
68,000 square feet

CAPACITY
15,000-30,000 people



**NEW YORK STATE
FAIRGROUNDS**

Chevy Court

Chevy Court
Site Map

Total Area – 139, 125 sq. ft.
Usable Area – 108, 725 sq. ft.

